

## Bearing, Drive Shaft in Clutch Housing, Replace

1. Illustration of drive shaft
  1. Spacer sleeve
  2. Drive shaft bearing

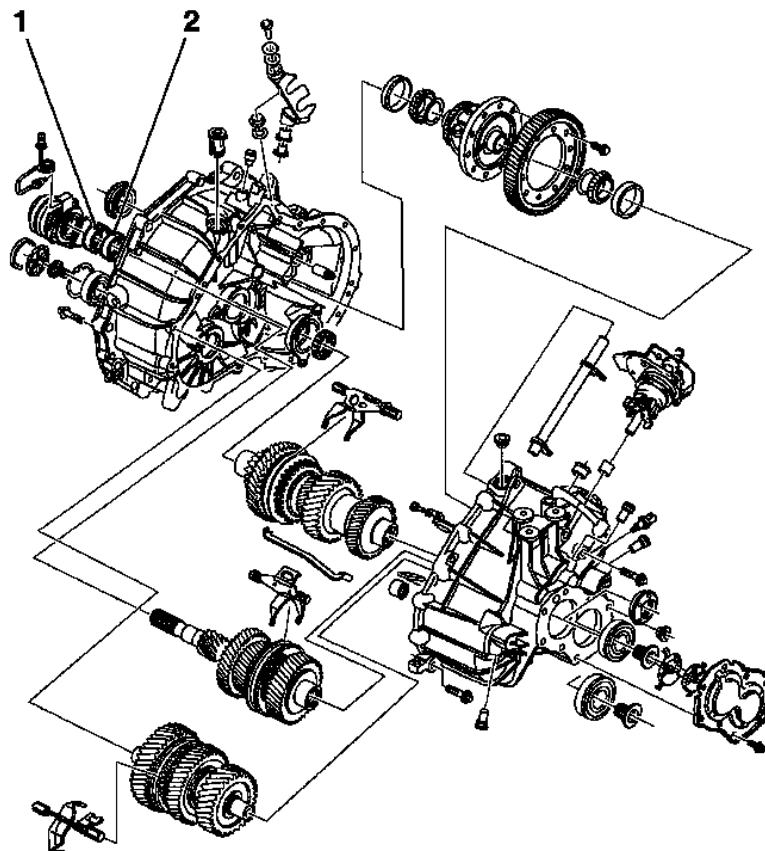

L 2544

2. Remove transmission from vehicle- see operation "Transmission, Remove and Install"
3. Disassemble transmission - see operation "Transmission, Seal Completely"
4. Remove drive shaft bearing (4) and spacer sleeve (3) from clutch housing with **KM-248-2** (1) and **KM-248-4** (2)

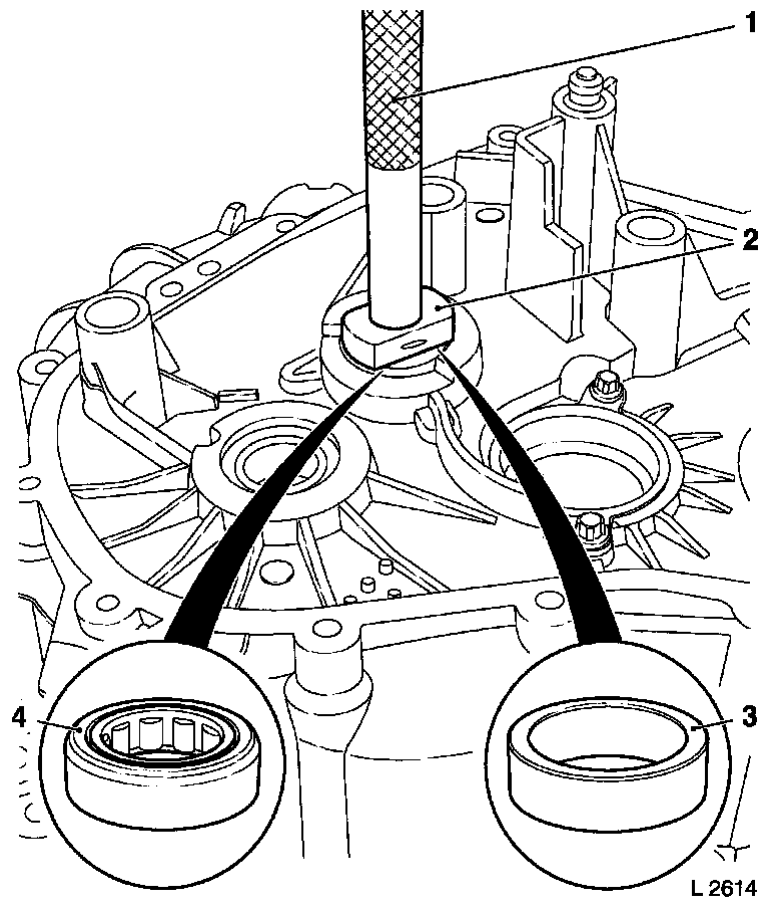

5. Clean all removed parts and check for wear and damage; replace if necessary

6. Install drive shaft bearing (3) into clutch housing with **KM-6120** (2) in conjunction with **KM-523-1** (1). Rounded-off side (arrows) of drive shaft bearing points to spacer sleeve

7. Install spacer sleeve (4) into clutch housing with **KM-6112** (2) in conjunction with **KM-523-1** (1)

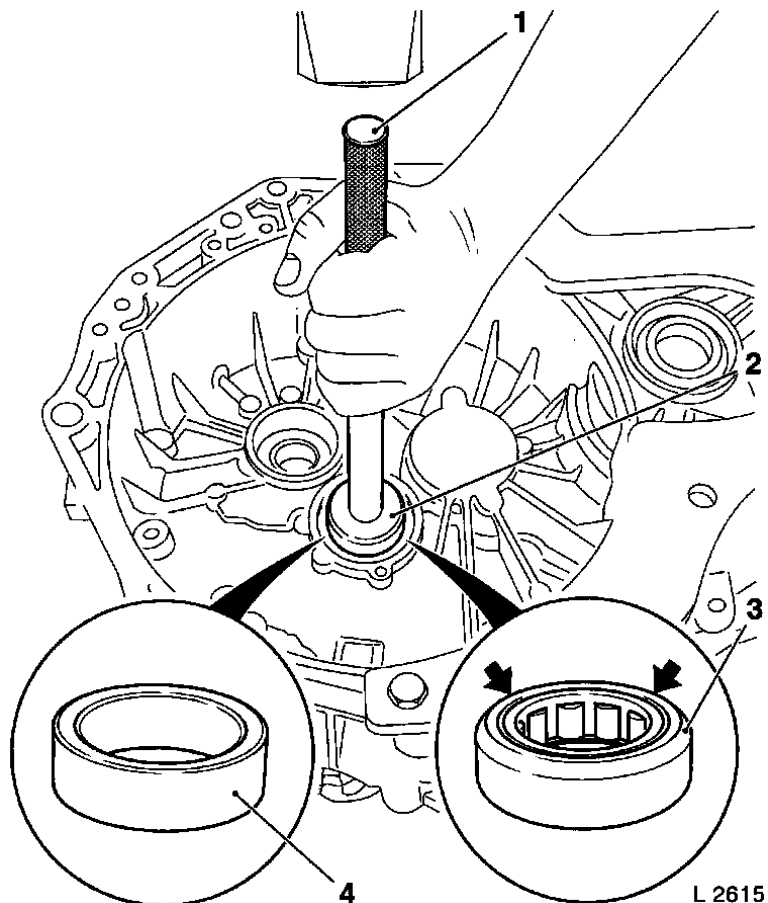

8. Assemble transmission - see operation "Transmission, Seal Completely"
9. Install transmission into vehicle- see operation "Transmission, Remove and Install"